

ALTERNATE LOCATION FILTER MOUNTING **INSTALLATION INSTRUCTIONS** **FOR HAC and EMABF MODELS**

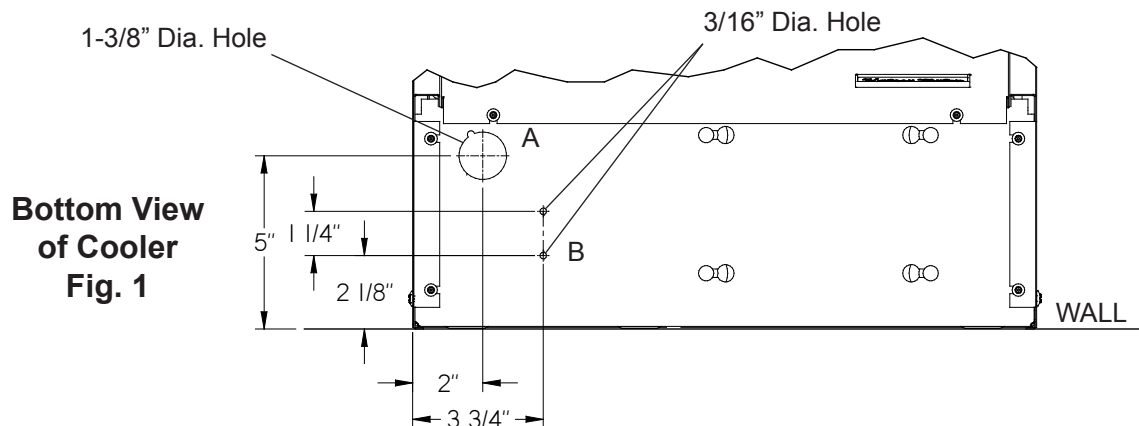

Alternate Filter Mounting Location Fig. 2

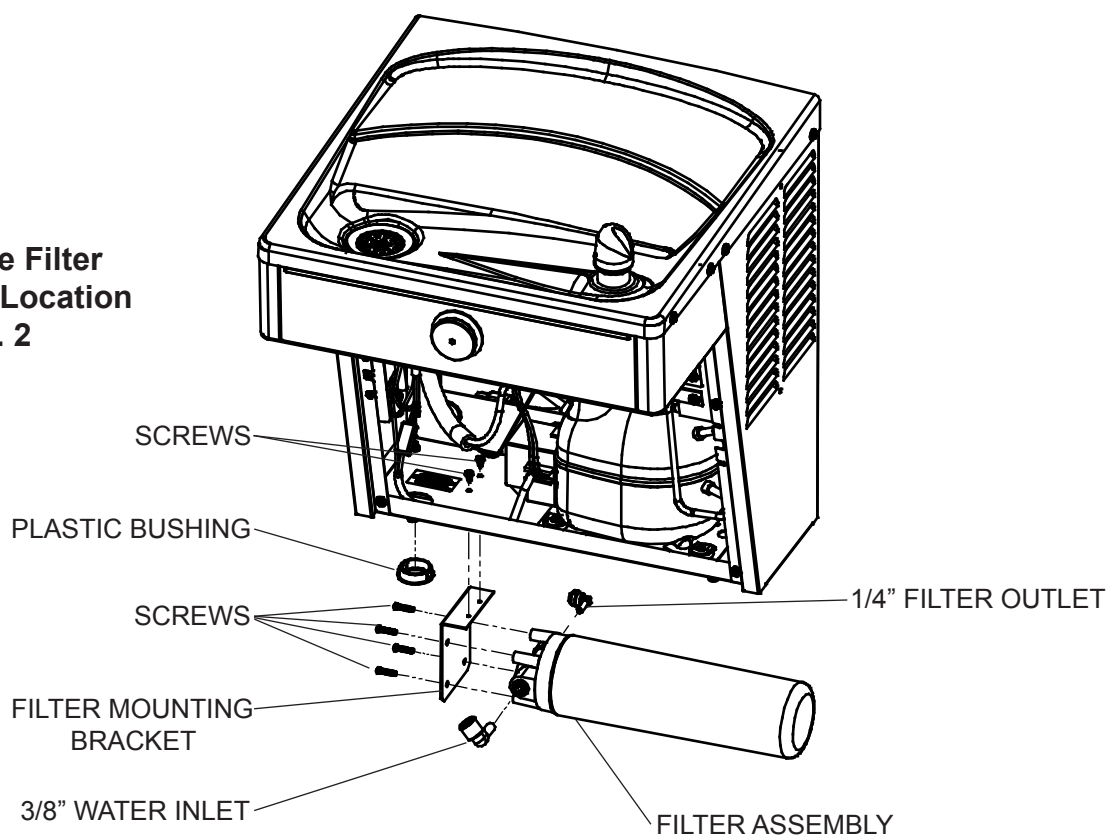

- 1) Using a 3/8" drill. Drill a 3/8" pilot hole for the supplied punch at location "A" using the dimensions shown in Fig. 1.
- 2) Using the 1-3/8" dia. punch supplied with 98670C Kit - Retro Filter Mounting, punch a 1-3/8" dia. hole "A" at the 3/8" pilot hole.
- 3) Using a 3/16" dia. drill. Drill two holes at location "B" using the dimensions shown in Fig. 1.
- 4) Remove Filter bracket from filter assembly and reinstall as shown in Fig. 2. Be sure the 3/8" water inlet is facing out.
- 5) Install plastic bushing (supplied) as shown into 1-3/8" hole, bushing must be used so water lines will not be cut by sharp edges of base plate.
- 6) Install filter assembly to bottom of cooler as shown in Fig. 2 with 2-#8 sheet metal screws (supplied).
- 7) Run the inlet and outlet water lines to filter.
- 8) Sold separately: P/N 98668C Filter Mounting Cover (Platinum Vinyl), P/N 98669C Filter Mounting Cover (Stainless Steel) or P/N 1000000887 Filter Mounting Cover (Light Gray Granite) may be ordered to enclose the filter beneath the cooler (Not Shown).